

ADDENDUM NO 03

CITY OF FAIRHOPE

to

BID NUMBER 015-15, Fairhope Soccer Complex 2015 – FENCING PROJECT NO. REC 001-15, New Fairhope Soccer Complex Project 2015

The bid documents for this Bid shall be amended, revised, and changed in the following particulars:

Tax Questions:

1. Is the project Tax Exempt?
ANSWER: Yes, once Form ST: EXC-01 has been submitted to and approved by the Department of Revenue.
2. What if the tax rate is different than the 9.0% at the point of purchase of materials?
ANSWER: The tax number is an estimate for obtaining the Sales and Use Tax Certificate. If the Bidder's materials suppliers are known to be in an area of a higher sales tax, then the Bidder would use that tax rate for his estimate.
3. On form ACCOUNTING OF SALES TAX ATTACHMENT TO BID, The contractor will specify their base bid and alternate bid, if any, and the total estimated sales tax associated with the base or alternate bid. Is that correct?
ANSWER: Yes. The Base Bid sales tax line item is for the Base Bid only. Each Alternate has its own sales tax line item for that alternate only.
4. Sod is typically considered an agricultural product and is not taxed. If the material is not taxed do they need to apply the tax rate to the item?
ANSWER: If the materials are not typically taxed, then you would not include them in the materials that you are basing the taxable measure on.

Per section 1.24 the tax forms must be filled out to have a responsive bid. The Tax forms however will have no effect on the recommendation for low bid.

Submitted by:

PREBLE-RISH, LLC



Andrew N. Bobe, P.E.

Responders are to sign and include signed Addendum No.3 with submitted bid documents.

Acknowledged:

Company

By

Date

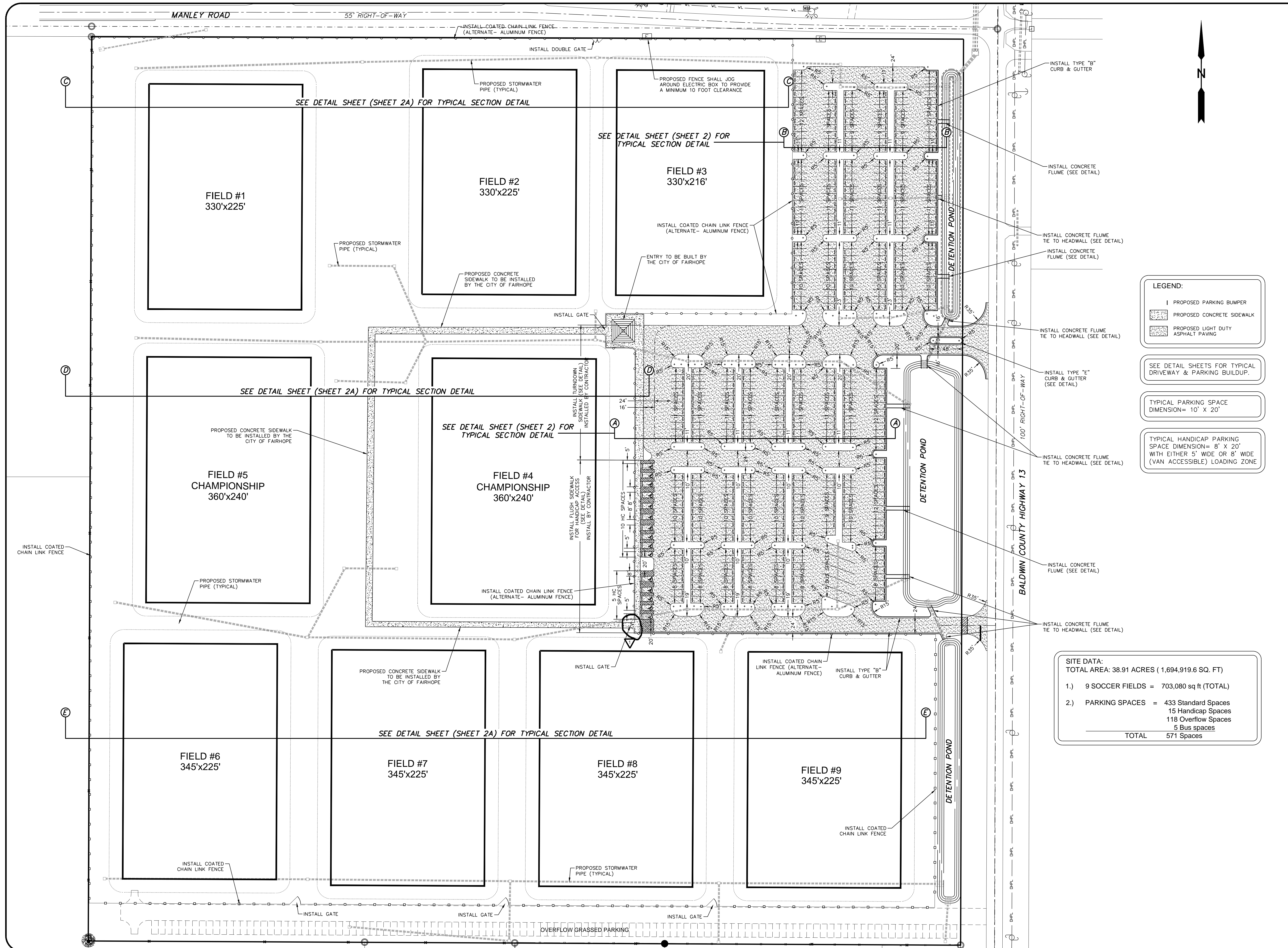

LEGEND:

- PROPOSED PARKING BUMPER
- PROPOSED CONCRETE SIDEWALK
- PROPOSED LIGHT DUTY ASPHALT PAVING

SEE DETAIL SHEETS FOR TYPICAL DRIVEWAY & PARKING BUILDUP.

TYPICAL PARKING SPACE DIMENSION = 10' X 20'

TYPICAL HANDICAP PARKING SPACE DIMENSION = 8' X 20' WITH EITHER 5' WIDE OR 8' WIDE (VAN ACCESSIBLE) LOADING ZONE

SITE DATA:
 TOTAL AREA: 38.91 ACRES (1,694,919.6 SQ. FT.)

1.)	9 SOCCER FIELDS =	703,080 sq ft (TOTAL)
2.)	PARKING SPACES =	433 Standard Spaces
		15 Handicap Spaces
		118 Overflow Spaces
		5 Bus spaces
	TOTAL	571 Spaces

PREBLE-RISH, LLC
 CONSULTING ENGINEERS
 CIVIL • SURVEYING • SITE PLANNING

990 BELLEVUE AVENUE
 DAPHNIE, AL 36028
 (205) 890-9900
 www.preble-rish.com

ABAMA
 LICENSED PROFESSIONAL ENGINEER
 NO. 30021
 ANDREW W. RISH

REVISION:

NO.	DATE	APPR.	DESCRIPTION
1	8/18/15	ANB	SINGLE GATE REUSE TO DOUBLE GATE AT SOUTH END OF PARKING LOT.
2			
3			
4			
5			
6			
7			

SCALE: 1" = 80'

DESIGNED: ANB/CCJ
DRAWN: CCJ
CHECKED: ANB
DATE: APRIL, 2014

PROJECT NO: 385.0003
SHEET: 03

SITE GEOMETRICS & FENCE PLAN
FAIRHOPE SOCCER FIELDS
CITY OF FAIRHOPE
FAIRHOPE, ALABAMA